

with unlocking by rod (hoistway side)

To replace :

SV3 lock (Soretex) on double hinged landing door (T120).

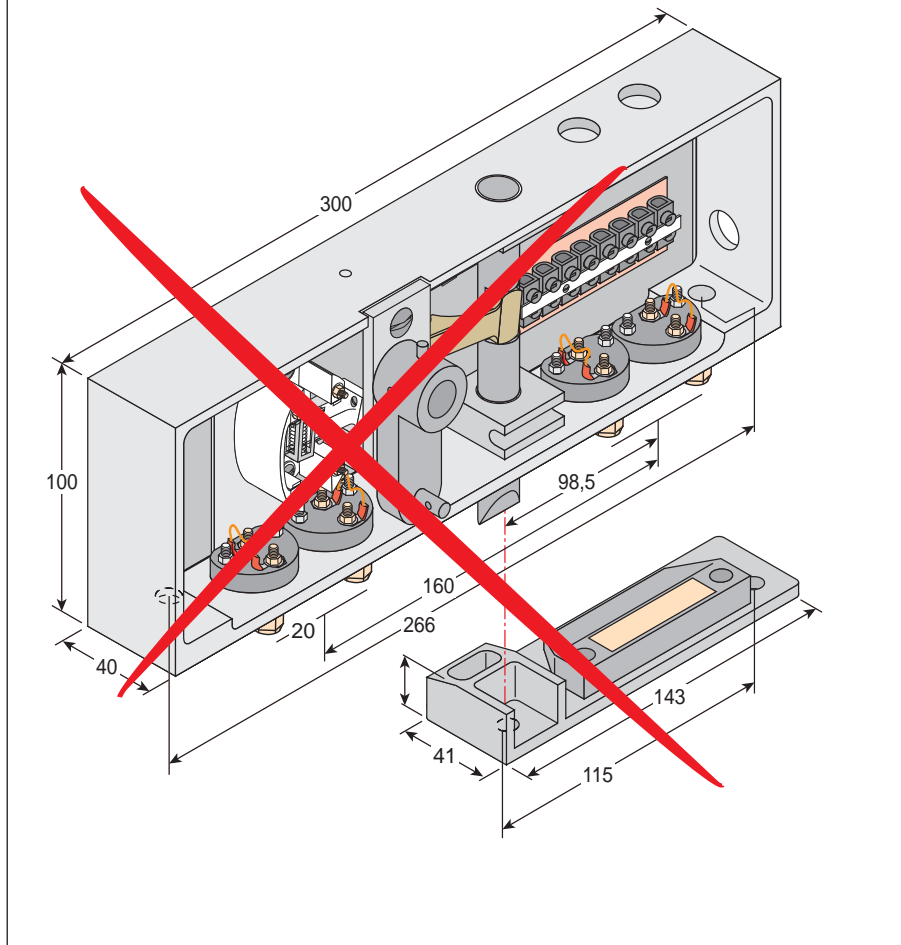

Substitution :

LR 180 \*\* SV3-T120 (prudhomme S.a.)

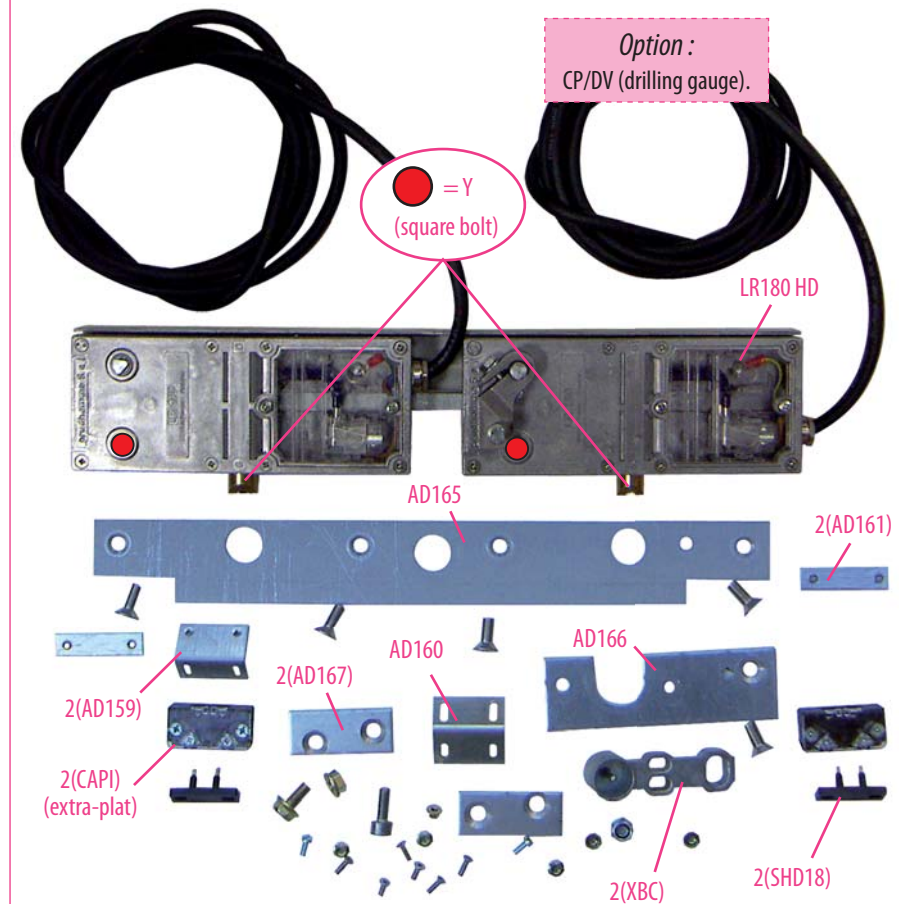

Screws :

FHC 4x10 (x2) ; M4 with base plate (x2) ; CHC M4x6 (x4) ; discs M4 (x4) ; FS 4x6 (x4) ; FHC M8x25 (x2) ; FHC M8x20 (x3) ; CHC M8x20 (1) ; M8 with base plate (x1)

réf. : LR180 **HG** SV3-T120

réf. : LR180 **HD** SV3-T120

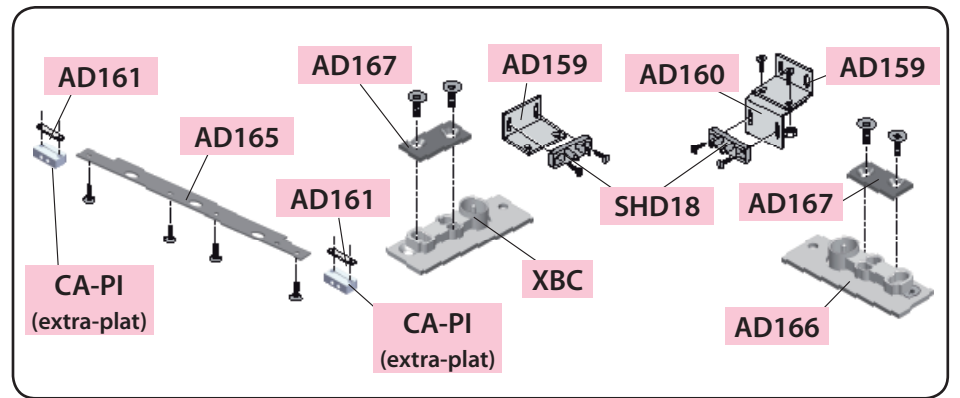
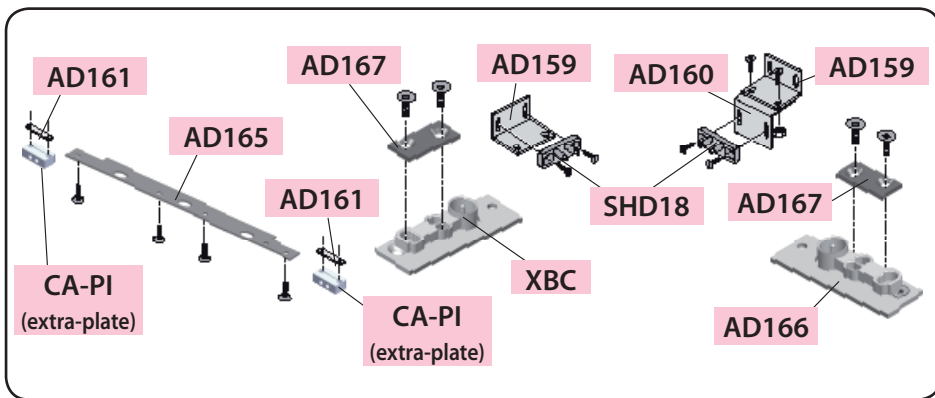
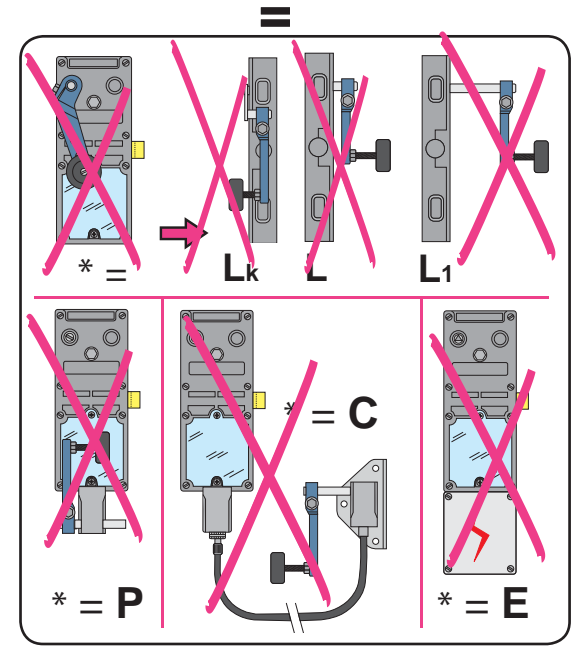
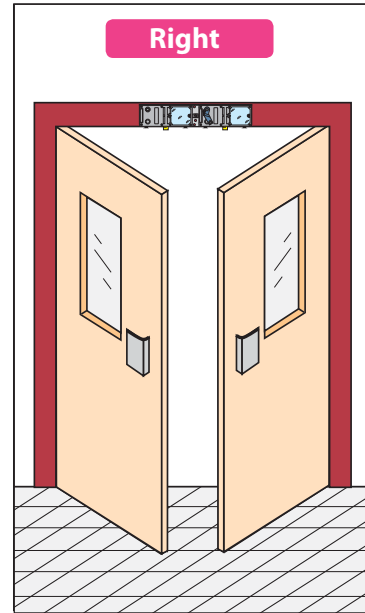
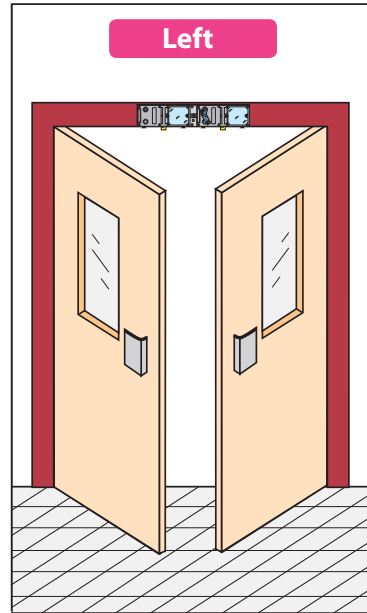
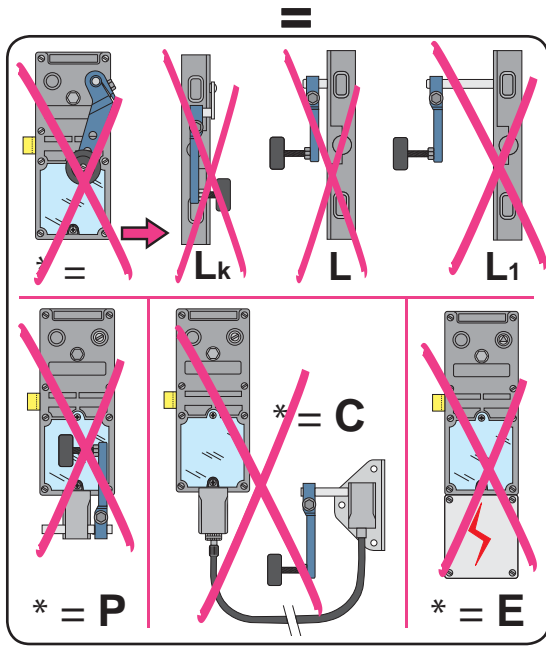

with unlocking by rod (hoistway side)

## Mounting stages

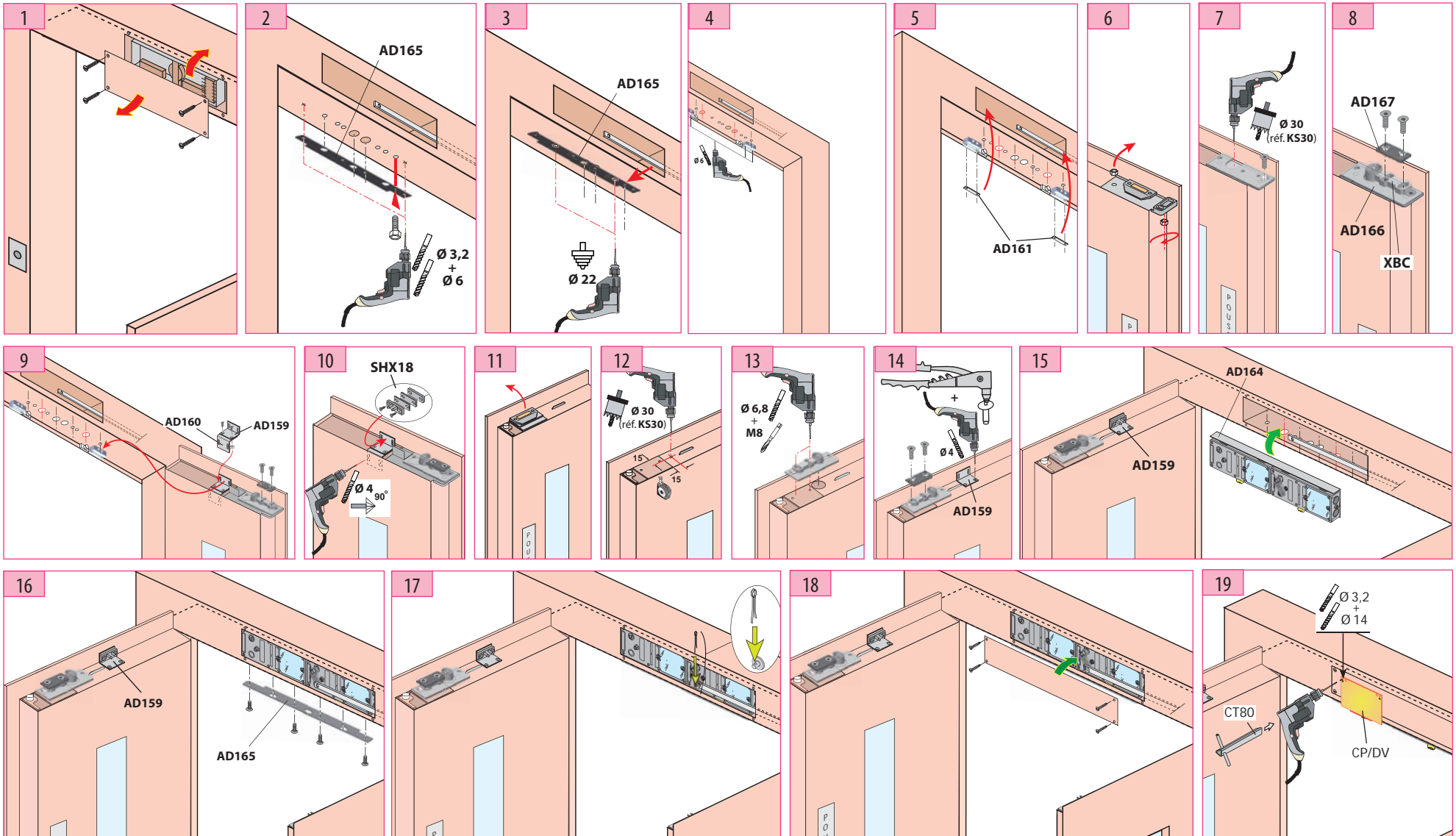
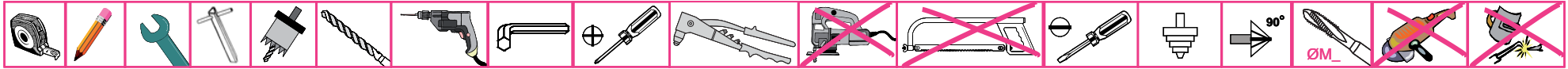

Incl. A du 04/01/2011

FP

Document non contractuel, sous réserve de modification - Reproduction interdite.

For double hinged landing doors

43 622

SETTING UP THE UNIT